



**5, Southville Close, Radbrook Green, Shrewsbury, SY3 6BW**  
£900 Per Month





5, Southville Close, Radbrook Green, Shrewsbury, SY3 6BW

**£900 Per Month**

VIRTUAL TOUR AVAILABLE: Modern two bedroom semi detached house in the popular location of Radbrook Green, a short distance from Royal Shrewsbury Hospital. Excellent access to local schools and amenities.

Available: Immediately

## Description

Comprising: Hall, living room, modern kitchen including dining area, two bedrooms, new bathroom including shower. Front & rear garden, driveway parking for multiple cars, gas central heating, double glazing. EPC TBC



Unfurnished

Council Tax Band: B

Available: 13th January 2026

EPC:

## Floor Plans

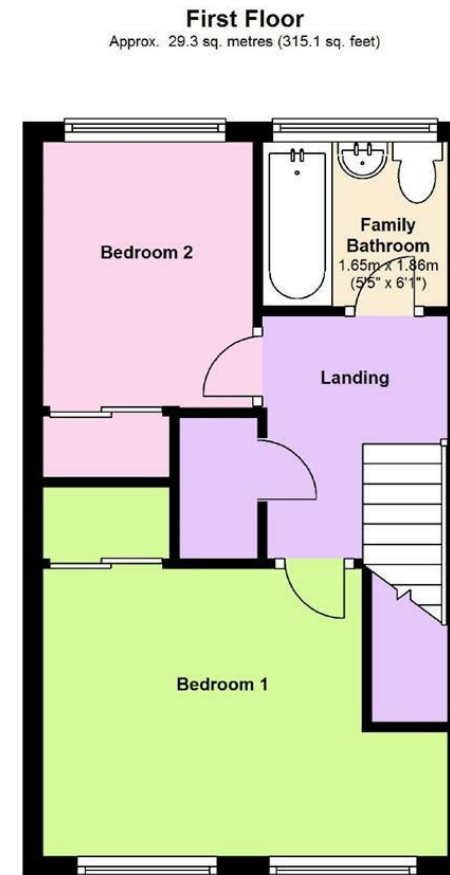
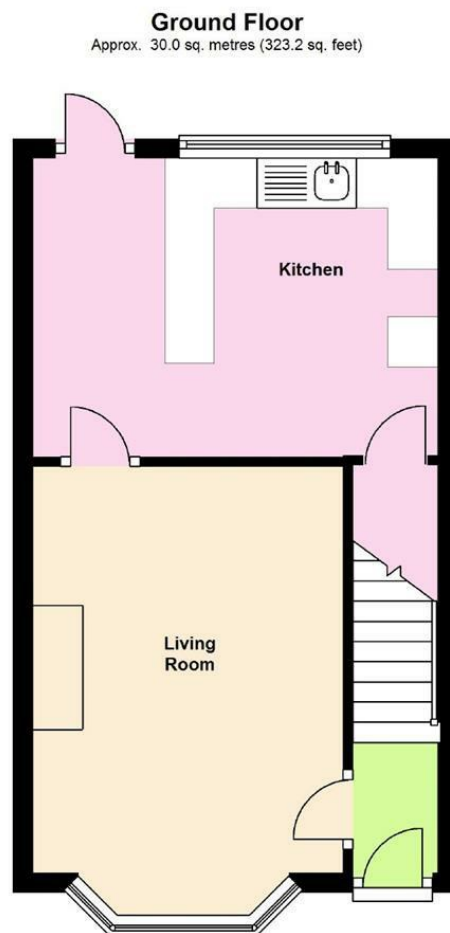

Total area: approx. 59.3 sq. metres (638.3 sq. feet)

We accept no responsibility for any mistake or inaccuracy contained within the floorplan. The floorplan is provided as a guide only and should be taken as an illustration only. The measurements, contents and positioning are approximations only and provided as a guidance tool and not an exact replication of the property.

Plan produced using PlanUp.

These particulars, whilst believed to be accurate are set out as a general outline only for guidance and do not constitute any part of an offer or contract. Intending purchasers should not rely on them as statements of representation of fact, but must satisfy themselves by inspection or otherwise as to their accuracy. No person in this firm's employment has the authority to make or give any representation or warranty in respect of the property.